

# TRACE 1300/1310: Manual Injection Kit for Gas Sampling Valve (GSV) - Installation Guide

This guide provides instructions for installing the kit P/N 19050784 on the Sample IN port of the Gas Sampling Valve (GSV) injector for performing manual injection.

## Contents

- [Introduction](#)
- [Getting Started](#)
- [To install the kit for manual injection](#)

## Introduction

The kit includes the following parts. See [Figure 1](#).

**Figure 1.** Kit for Manual Injection

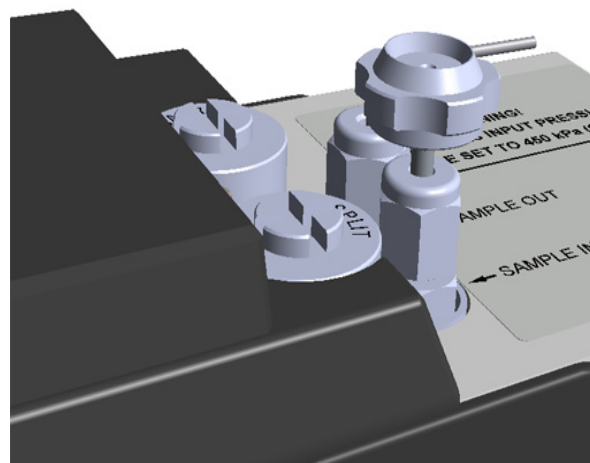
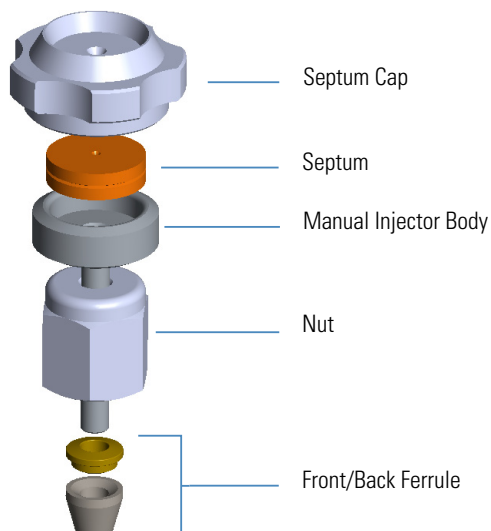

## Getting Started

Install the kit for manual injection following the instructions in the next operating procedure:

- [“To install the kit for manual injection” on page 2](#)

❖ **To install the kit for manual injection**

1. If already connected, disconnect the inlet sample line from the **Sample IN** port on the GSV module. See [Figure 2](#).

**Figure 2.** Inlet Sample Line Disconnection

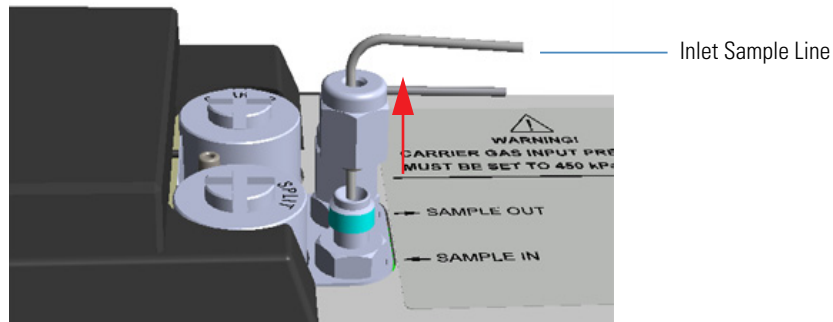

2. Using the nut and front/back ferrule provided, install and the manual injector body into the **Sample IN** port on the GSV module. See [Figure 3](#).

**Figure 3.** Installation of the Kit for Manual Injection (1)

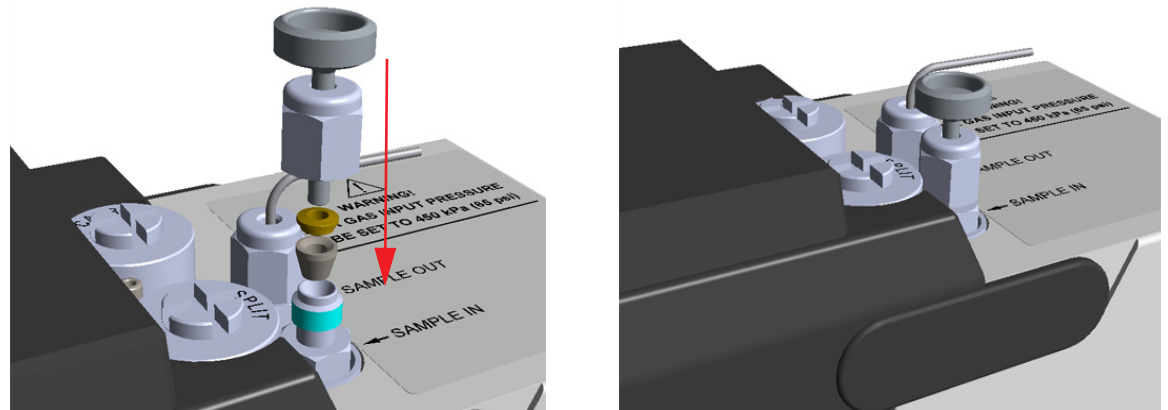

3. Avoid touching the septum with your fingers. Insert a new septum into the manual injector body using tweezers.
4. Screw and tighten the septum cap to finger-tight. See [Figure 4](#).

**Figure 4.** Installation of the Kit for Manual Injection (2)

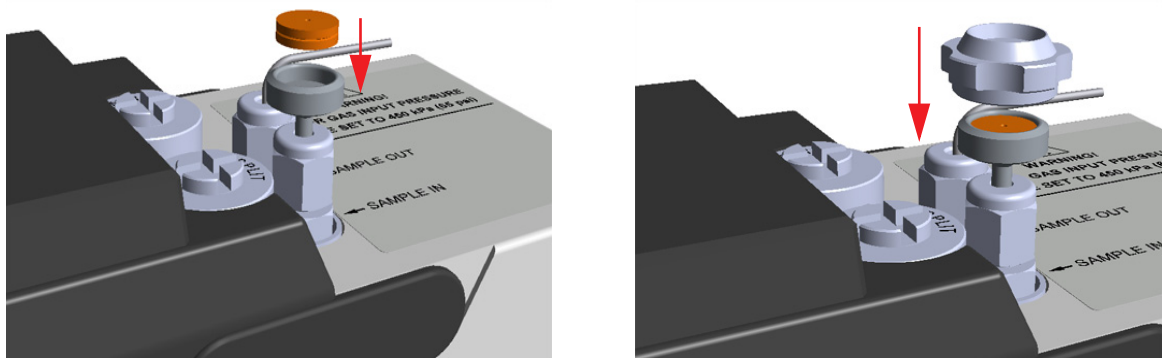

**CAUTION** Do not overtighten the septum cap because you might damage the septum and affect instrument performance.