

# High Flow Solution

The Waste Disposal System  
for Viscous Chemicals.

- ✓ **Fast draining without congestion**
- ✓ **Durable**
- ✓ **Easy to clean**



Gives you the ability to collect liquid waste directly within the fume cabinet - thereby avoiding the awkward use of canisters. Hence, more working space is made available. Liquid level control allows for continual supervision of the canisters, even from outside.

**90° Drop**  
for viscous waste  
and high flowrates.

**Fire Protection**

Feed duct conforms with fire protection regulations

**Automatic Drip Protection**

prevents any dripping of residual liquid into the safety cabinet

**Safety Funnel**

with hinged lid

**Main Pipe**

- V4A stainless steel
- Easy to clean

**Leading Pipe**

for installation within the worktop

**Liquid Level Control**

**Direct Extraction**

of fumes and hazardous substances at the canister opening

**Earthing Connection**

prevents spontaneous ignition

**Capacitive Liquid Level Control Sensor**

**Safety Canister**

PE-HD EL ( $\leq 10^9 \Omega$ )

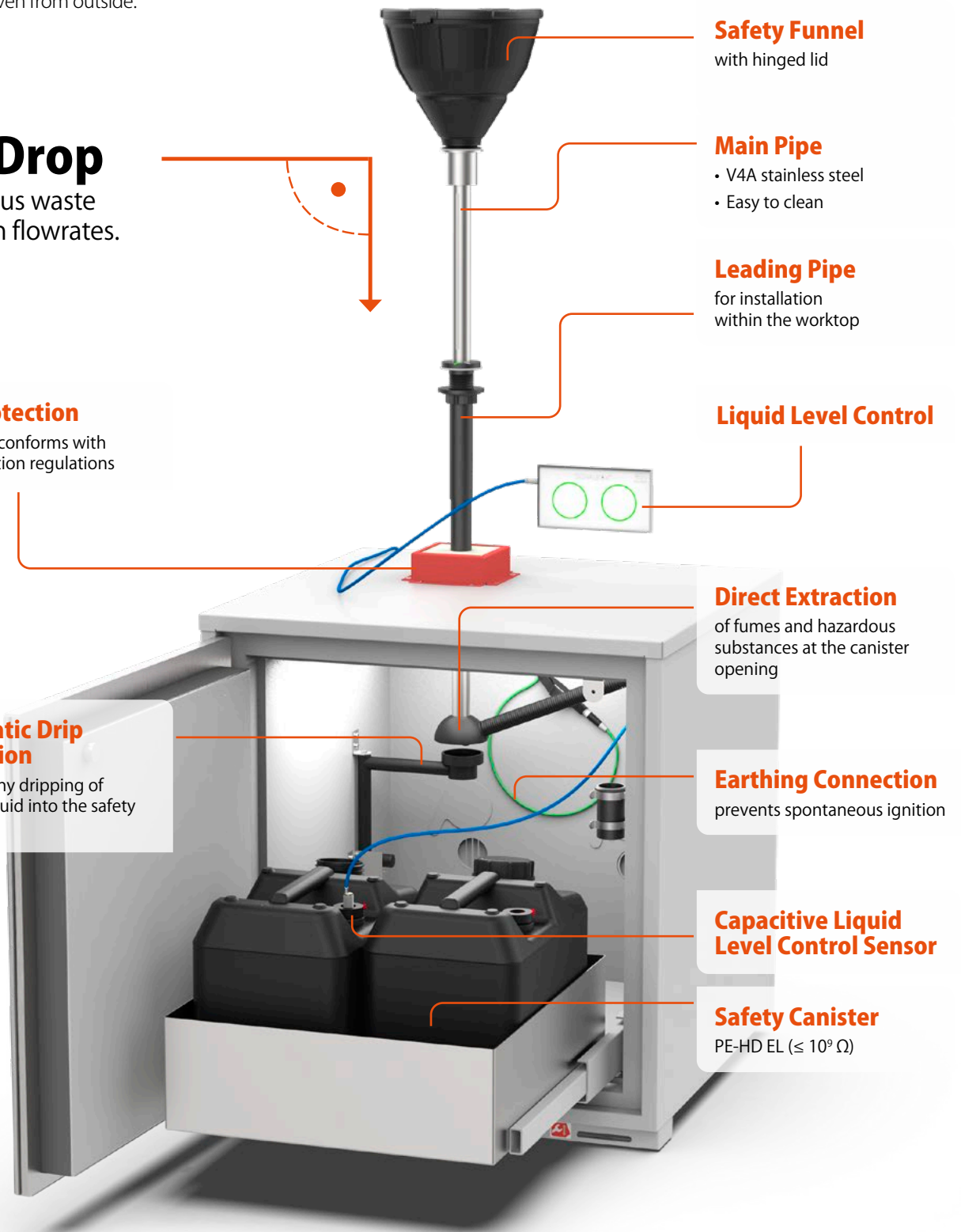

- ✓ **Fast canister exchange**
- ✓ **High degree of working comfort**
- ✓ **Safety Cabinet remains clean**

Fast and simple canister exchange - this was one of the demands on the High Flow Solution from our customers. The main pipe with a 90° drop is simply pulled up, in order to disconnect the canister.

The automatic drip protection collects residual liquid from the pipe, thereby ensuring that the safety cabinet remains clean.

After exchanging the canisters, the system is simple to reconnect and can then be immediately reused.



- ✓ **Safely closed**
- ✓ **Easily cleaned**
- ✓ **Time saving**

### Safety First

Each component of the system has been designed for maximum safety, smart handling and easy cleaning - in order to save on time and work involved.

#### Safety Funnel

Hinged lid with sealing ring for secure closure, when the funnel is not in use.

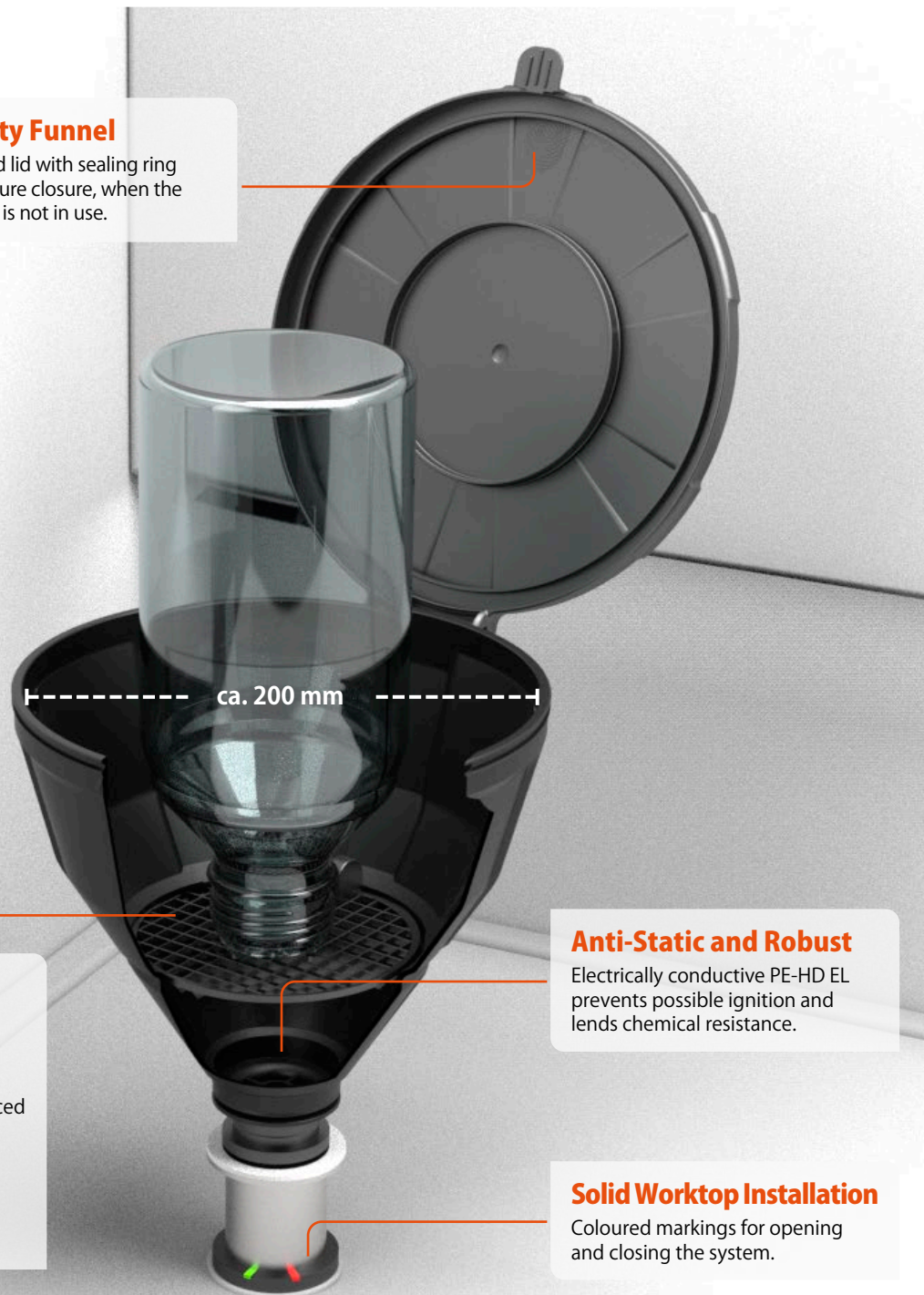

#### Dirt-Collecting Sieve

Collects magnetic stirrers, to prevent them falling into the canister.

Test tubes or bottles may be placed upon the sieve and drained. This gives you more time for doing other things.

The dirt-collecting sieve can be removed for cleaning.

#### Anti-Static and Robust

Electrically conductive PE-HD EL prevents possible ignition and lends chemical resistance.

#### Solid Worktop Installation

Coloured markings for opening and closing the system.



✓ **Ease of  
handling**

Don't take any risks regarding health and safety: the liquid level memo function reminds you to replace the sensor after canister exchange - this, for safe monitoring of your liquid levels and to prevent any overflowing.

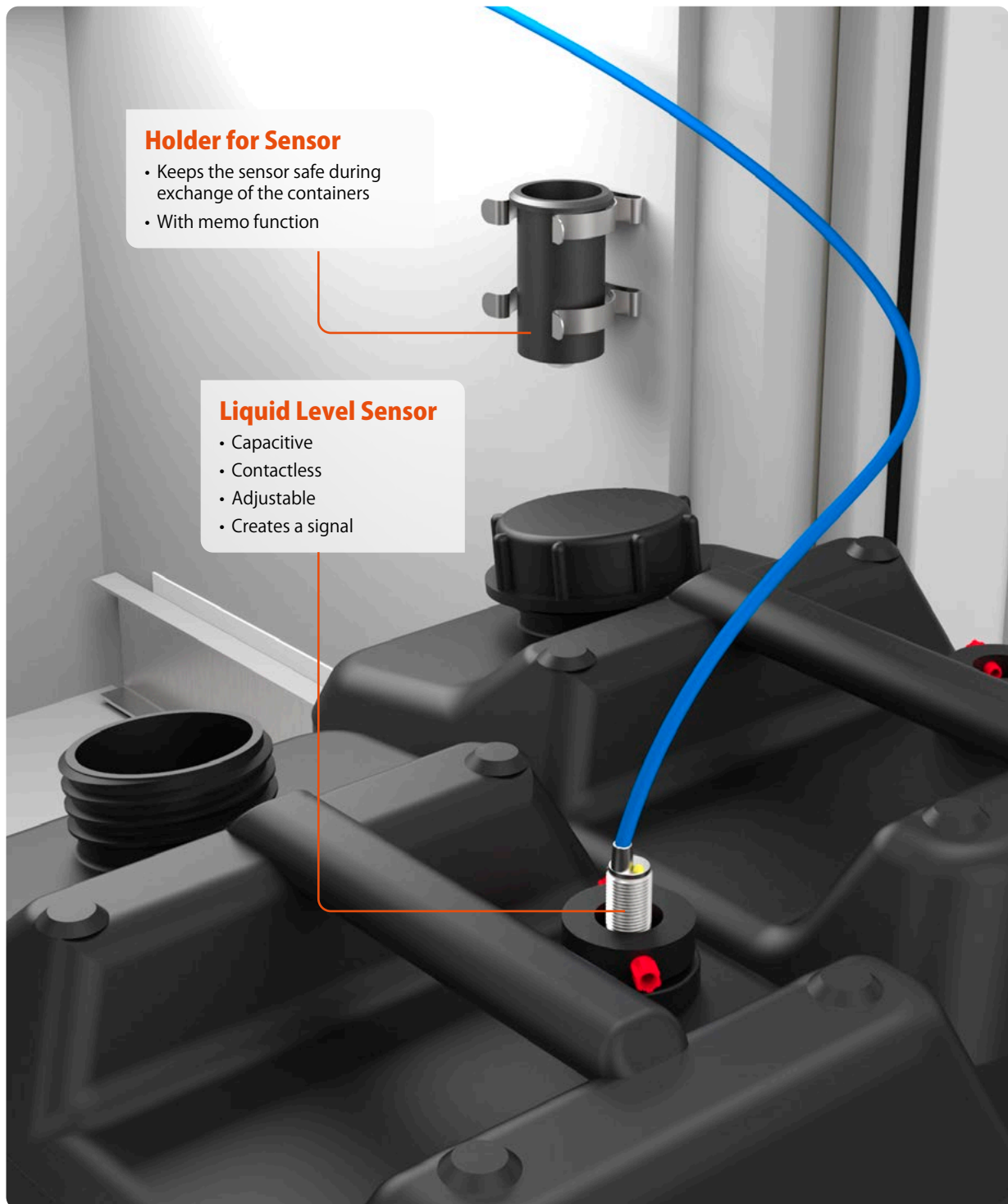

The automatic drip protection is activated, whenever the cabinet is opened. Residual liquids are thereby prevented from contaminating the interior of the safety cabinet.

We even offer double the safety as regards fume extraction, as the exhaust hood removes additional vapours - directly from the opening of the canister.

### Direct contact to Your SymLine<sup>®</sup> specialist

+49 (0) 61 05 / 30 55 86 - 47  
info@scat-europe.com  
www.symline.de



Contact Form >

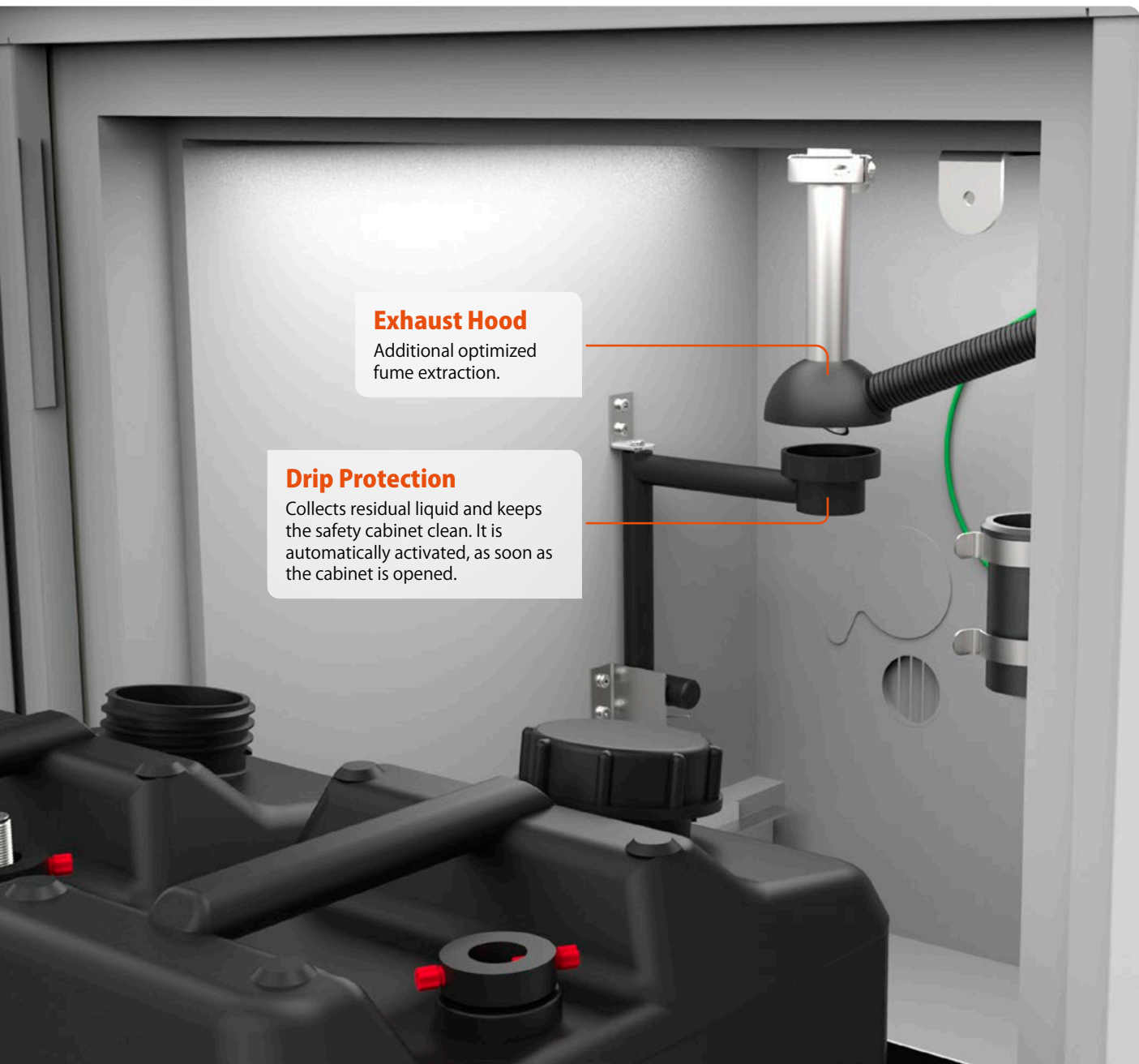

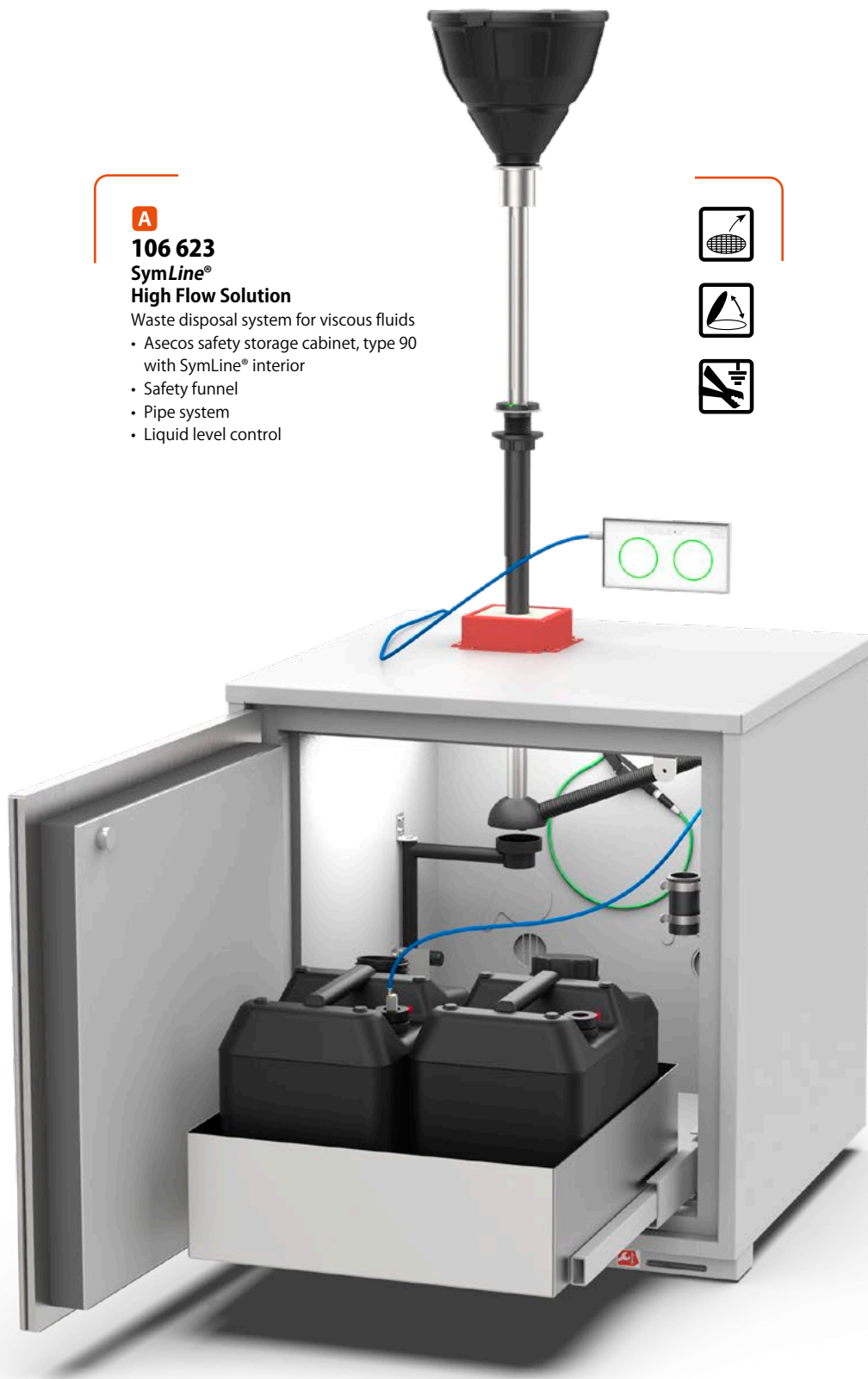

**A**

**106 623**  
**SymLine**<sup>®</sup>  
**High Flow Solution**

- Waste disposal system for viscous fluids
- Asecos safety storage cabinet, type 90 with SymLine<sup>®</sup> interior
  - Safety funnel
  - Pipe system
  - Liquid level control



Intro

Filling Units

Pipe System

Disposal

Level Control

High Flow Solution

FLEX

Accessory

Fig.	Part No.	Description
<b>A</b>	106 623	<b>SymLine</b> <sup>®</sup> High Flow Solution